

# Cladding Profile

## Metalbenz Flush Lock Seam Panel



Use this profile with a wide range of metals

Metalbenz fabricates an interlocking and overlapping flat sheet panel known as a 'flush lock' panel. This panel is a variation on the 'flat lock' panel. Like the flat lock panel, it is flat with 30 – 40 mm folds around the perimeter of the panel, but the flush lock panel differs as the folds on two sides of the panel are recessed by the thickness of the material itself. These folds are formed simply to interlock and overlap with each other, so that the end visual result is a slim line where the joint is located. With the two recessed side panels, a shadow gap of 2 – 10 mm can be achieved. This is technically referred to as a 'ship-lap' panel, where the face of the panel is flush.

Each panel is installed sequentially with the lower fold of each panel interlocking with the upper fold of the panel below. The upper and side panels are attached to the roof with clips which are concealed by the next overlapping panel.

### Factors

- Panel Width:** 200 – 400 mm.
- Panel Height:** Flat.
- Panel Length:** Varies with width of material.
- Variations:** Horizontal, vertical, diagonal, brick pattern, curved.
- Benefits:**
  - Flush lock seam panels can be large squares that are more likely used in modern contemporary buildings.
  - Elegant solution as the method creates joints that appear as slim shadow lines.
  - This method is very popular for walls, soffits and curves.

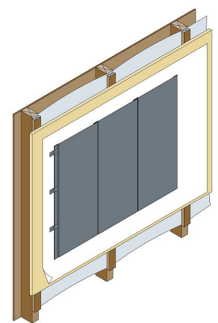
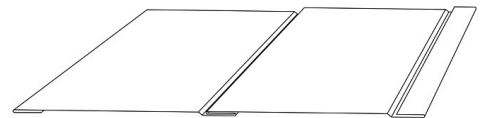

**Metal** benz  
FABRICATION

[www.metalbenz.com.au](http://www.metalbenz.com.au)

Visit our website to see our full range of profiles for roofing and wall cladding. We also custom fabricate flashings, rainwater systems and supply pre-fabricated systems.

Phone: 02 9986 0891